

SC

Mordaza manual 

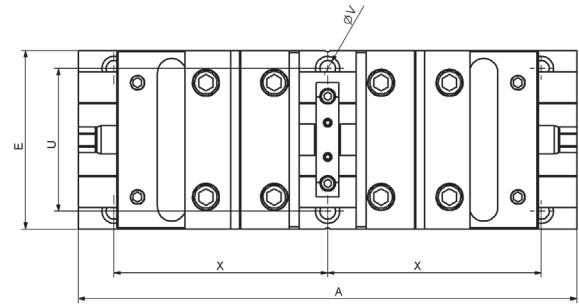
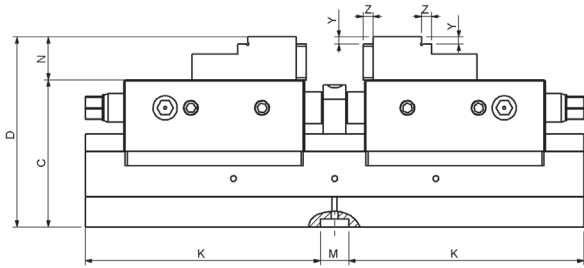

Tamaño	70	90	125	125 L	125 XL
Arnold SC	050 200 70	050 200 090	050 200 125	050 202 125	050 203 125
Fuerza de amarre	11kN / 30 Nm	18 kN / 60 Nm	32 kN / 120 Nm	32 kN / 120 Nm	32 kN / 120 Nm
A	140	250	350	450	550
C	73	100	103	103	103
D	96	130	133	133	133
E	72	93	125	125	125
K	63	115	165	215	265
M H7	14	20	20	20	20
N	23	30	30	30	30
U	60	71	100	100	100
V	7	11	11	11	11
X	62	100	150	189	252
Y	3	5	5	5	5
Z	3	6	7	7	7
Peso (kg)	5	14,3	30	39	43

Amarres	70	90	125	125 L	125 XL
Campo de amarre O1	6-36	12 - 77	14 - 108	14-108	14-208
Campo de amarre O2	46-76	79 - 145	108 - 204	204-300	204-400
Campo de amarre O3	35-65	59 - 125	82 - 178	82-178	82-278
Campo de amarre O4	75-105	127-193	178 - 274	274-370	274-470
Campo de amarre O5	43-73	64 - 129	82 - 176	82-176	82-276
Campo de amarre O6	83-113	131 - 197	176 - 272	272-368	272-468
Campo de amarre O7	72-102	111 - 177	150 - 246	150-249	150-346
Campo de amarre O8	112-142	179 - 245	246 - 342	342-435	342-538

Posibilidades de amarre

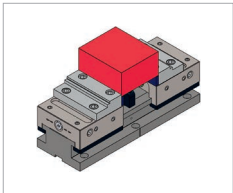

Campo de amarre O1

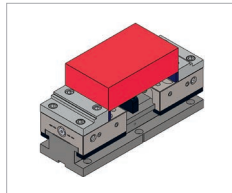

Campo de amarre O2

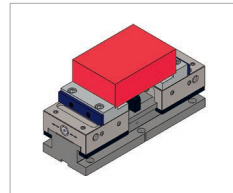

Campo de amarre O3

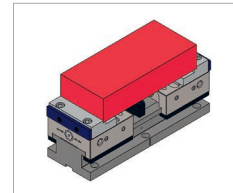

Campo de amarre O4

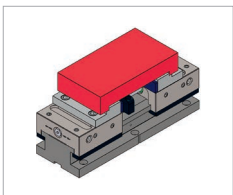

Campo de amarre O5

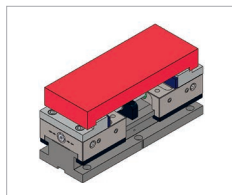

Campo de amarre O6

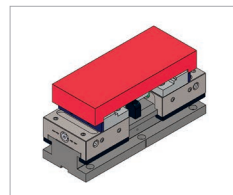

Campo de amarre O7

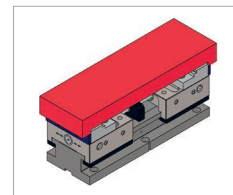

Campo de amarre O8

Preinstalación sistema punto cero

Esta mordaza incluye la preinstalación del sistema de amarre punto cero | **O-MAK**.

